

transparency, translucency and privacy.

While efficient 80%/20% direct/indirect full-spectrum lighting is used throughout the work areas to alleviate eye strain and computer glare, the lobby, gallery and circulation areas are lit primarily with incandescent sources such as low-voltage halogen lamps to provide a distinct ambience. Evoking glacial crevasses, concealed fluorescent strip lighting was used to emphasize the specific architectural elements of folded planes throughout the design. A translucent glass screen in the reception area of the Polar Capital headquarters captures natural light from the two windows behind it, diffusing it into an even and balanced source that washes through to the lobby.

As the founding members of Polar Capital are collectors of Canadian contemporary art and photography, a long gallery wall provides an interesting manner in which to display and experience the collection. The reflected ceiling lighting provides an even diffuse quality of illumination down the gallery corridor, enhanced by recessed pot lights directly aimed at the art pieces on the wall.

A range of other lighting applications within the workplace can be seen in the portfolio of BIH Design Consultants, established players in the corporate and commercial interior design industry. The firm's deft translation of their clients' desires for a clearly articulated corporate identity and brand is evident in the two projects featured here.

In a redesign of Aegon Financial's 28,000-square-foot facility, the cafeteria space forms a focal point for social interaction and break-out sessions. Within the framework of this international organization, the design is consistent throughout the space. Interior surfaces include a low-maintenance easy-to-clean floor and brilliant white mosaic tiles running partially up the wall, offering a textural contrast. To achieve a bistro-like ambience, the rhythmic march of the frosted filmed Plexiglas box fixtures (each containing six T5 fluorescents) above the round tables deliver abundant light with a softly diffuse quality. The brightness and orderliness conveys a hygienic quality appropriately suited to food services, and is in keeping with the overall design mandate for the office and for Aegon Financial's identity.

In a project for Delano Technology, a strategy of "mouse-hole" lighting offers an unusual design detail in a minimally pristine corridor space. While echoing the pattern of the recessed pot lights in the canted ceiling above, these incandescent floor-level light fixtures inset in the base of the partition also emphasize the rhythmic cadence of pedestrian movement down the corridor. The delight of this particular lighting effect can also be appreciated from the fully glazed client conference space located across the hall.

A successful example of lighting mastery in a smaller-scale residential application is evident in a modest project by Taylor Smyth Architects. An idyllic sloping lakeside site north of Toronto accommodates a 245-square-foot one-room cabin that manipulates light and view in a highly architectural manner. As an accessory building to the main cottage on this property located on the south side of Lake Simcoe, this exquisitely simple structure transforms sunlight into constantly shifting patterns in the cabin throughout the day. Appropriately, it is referred to as Sunset Cabin, indicating the time of day when its interior lighting effects are most dramatic and breathtaking.

Used year round, the cabin is fabricated of clear untreated cedar for window frames, doors and cladding. Floor-to-ceiling glass renders artificial lighting unnecessary during the day, and is protected by an exterior horizontal cedar screen that maintains privacy and helps brace against twisting forces. As natural daylight is integral to the cabin's design, the intricately detailed screen provides spectacular views of the setting sun from the bed, while irregularly and arbitrarily placed gaps between the individual slats provide views that principal Michael Taylor maintains "abstract the perception of the landscape into individual compositions of vegetation, water and sky." To minimize heat gain, the screen blocks direct sunlight at midday, while late-day sun is filtered by the screen into beautifully random geometric patterns that dance along the cabin's interior surfaces. The building captures the sun, transforming it into linear bands of light and shadow,



RICHARD JOHNSON



BIH DESIGN CONSULTANTS

TOP BOXY PLEXIGLAS SHADES CREATE A DIFFUSE YET BRIGHT AMBIENCE IN AEGON FINANCIAL'S BISTRO-LIKE CAFETERIA SPACE. ABOVE PLAYFUL MOUSE-HOLE LIGHTS WHERE THE WALL MEETS THE FLOOR AT DELANO TECHNOLOGY PROVIDE A SURPRISING COUNTERPOINT TO THE CLIENT CONFERENCE AREA OPPOSITE.



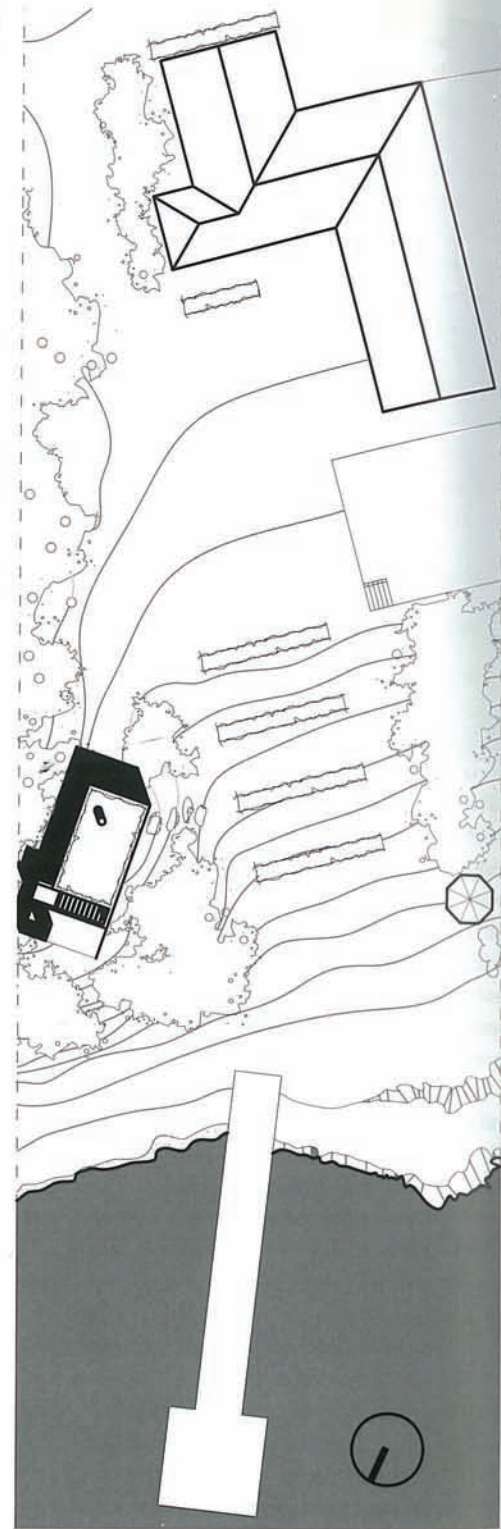

ephemeral sculptural formations that disappear only to return again the next day.

At night, the lighting effect is reversed, and the cabin becomes an object in the landscape, a lantern illuminating the water below. Artificial light reflects off the warmth of the cabin's birch plywood interior, emitting a honey-hued glow that radiates through the horizontal slats. To achieve this effect, a single row of MR-16 halogen pot lights runs the length of the cabin close to the glass wall to create an even wash of light, augmented by clip-on Tolomeo fixtures that light the recess at the head of the built-in bed.

Finally, the emerging practice of Gow Hastings Architects continues to update and enliven the campus of the Humber Institute of Technology &